



### ZIP WITH TURNS

A cable Zipline with turns  
An extremely safe, double cable zipline  
A zipline over longer distances carried by carrier cables  
Including a speed control system, to brake or to accelerate: *SPEEDCONTROL*



### THE ROPE PARK TRAILER

TRANSPORTABLE ADVENTURE

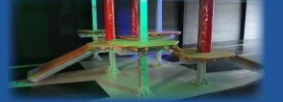

### ZIP TRACKS

INDOOR / OUTDOOR



### INDOOR ADVENTURE

FULLY EQUIPED INDOOR ADVENTURE PARKS



www.ap-projects.be

MAKING OUR **GLOBE**  
INTO ONE **BIG ATTRACTION**

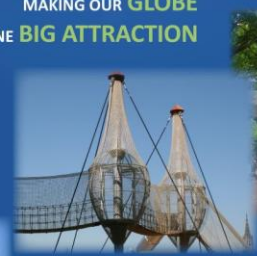

### SUSPENDING STRUCTURES

THE THRILL OF WALKING ABOVE NOTHING



### THE - POP UP - ROPE PARK

SELFSTANDING ADVENTURE



### HIGH ROPE PARKS

A SUSTAINABLE MODULAR  
STANDARD STRUCTURE WITH 4  
LEVELS OF ADVENTURE



### BIKE PARK EQUIPMENT

SKILL TRACKS FOR ALL LEVELS



### FLOATING HIGH ROPE ADVENTURE

HOPING YOUR BALANCE IS OK!! WATER IS WET!!



### TOWER STRUCTURES

FULLY EQUIPED ADVENTURE TOWERS



### 3D-LABYRINTH / 3D-MAZE

LOST FOR HOURS TO FIND THE EXIT

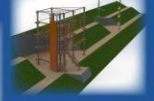
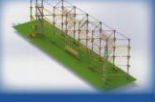
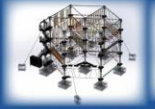

# INSPIRATION FOR CREATING A COMPLETE ADVENTURE PARK INDOOR / OUTDOOR / COVERED OUTDOOR

Part 1

MAKING OUR **GLOBE**  
INTO ONE **BIG ATTRACTION**



www.ap-projects.be

www.ap-projects.be

PROJECTS

## • Inspiration for creating an Adventure Park

### Objective of this presentation:

- To inspire, sketch, map and budget the possibilities regarding adventure experiences.
- This in order to discuss a budget and plan of approach.
- This concept is a guideline and a source of inspiration for all those who want to create an adventure park.
- The sustainability of the product and the amount of maintenance required will also be taken into account.

### Possible Contents

#### A. Adventure Activities, sports activities without lifelines and/or climbing protection in open air

1. Floating High rope park
2. Bike Park with sustainable obstacles.
3. Bouldering climbing rocks 3 m high with sand or fine loose gravel as fall arrestor
4. Low rope park, teambuildingpark
5. Low kids adventureropes
6. Obstacle runs
7. Sport and fitness tracks through the park for the fitness guru
8. Artificial caving
9. Nets park with high ropes
10. Kids Nets park with play & funelementments
11. 3D Labyrinth / 3D Maze with exits to find, to experience several attractions.

- **Inspiration for creating an adventure park**

- B. Outdoor activities with lifelines and/or climbing safety devices in open air
  1. High rope adventure with 4 floors and the difficulty levels kids, green, blue, red and black
  2. Standard climbing wall on climbing grips
  3. Quick jump
  4. Quick jump zip
  5. Straight multiple Ziplines
  6. Kidsziptrack
  7. Zip with turns
  8. Outdoor Funclimbing paradise
  9. Via Ferrata on boulderingrocks
  
- C. Indoor activities with lifelines and/or climbing safety.
  1. Standing or suspended High rope adventure with 3/4 floors and the difficulty levels kids, green, blue, red and black.
  2. An indoor multiple zipparadise, cruising on a zipwire through a building, light effects and dreamy music create a mystical atmosphere.
  3. All activities which can be built outside, can be created inside, even a suspending high rope park above a tropical swimming pool.



## • Activities without lifelines and/or climbing protection in open air

1. Floating High rope park
2. Bike Park with sustainable obstacles.
3. Bouldering climbing rocks 3 m high with sand or fine loose gravel as fall arrestor
4. Low rope park, teambuildingpark
5. Low kids adventureropes
6. Obstacle runs
7. Sport and fitness tracks through the park for the fitness guru
8. Artificial caving
9. Nets park with high ropes
10. Kids Nets park with play & funelemnts
11. 3D Labyrinth / 3D Maze with exits to find, to experience several attractions.

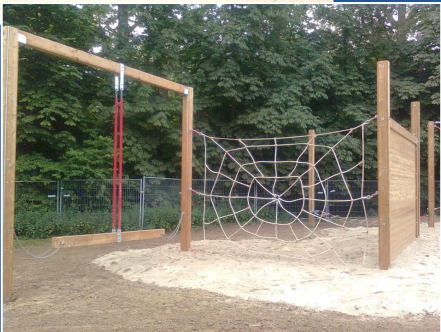

MAKING OUR **GLOBE**  
INTO ONE **BIG ATTRACTION**

**AP**  
&  
**PROJECTS**

[www.ap-projects.be](http://www.ap-projects.be)  
[www.ap-projects.be](http://www.ap-projects.be)

PROJECTS



Inspiration  
A1

## • Floating High Rope Park

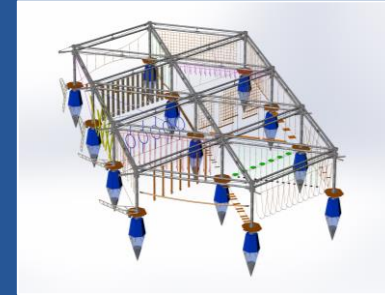
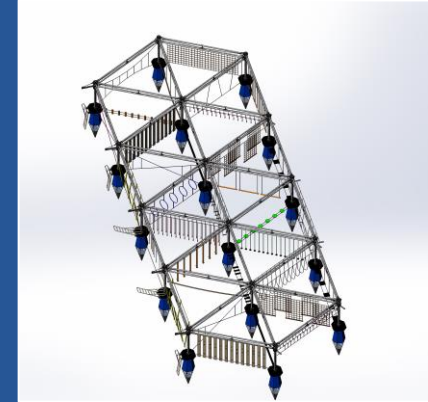
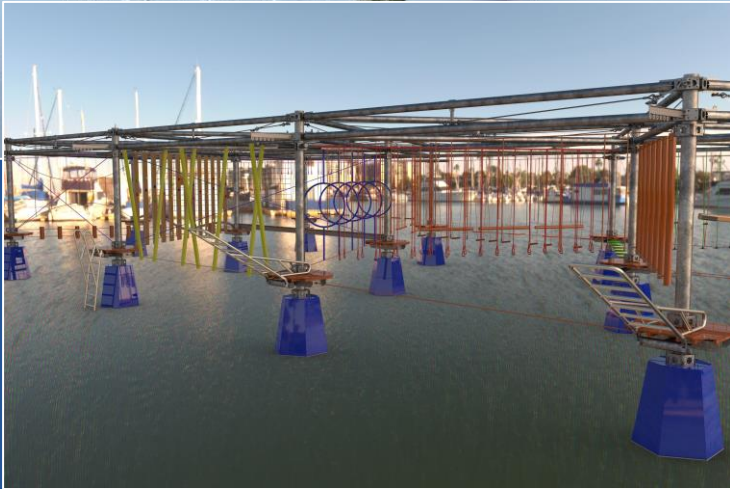

The structure is built to be used without a safety line in Spring, Summer and Fall. Only lifejacket, helmet and wetsuit for water below 18°C.

The structure is also built to be used with a safety line Double function on the same construction.

When winter kills your fingers and it's not pleasant to fall into the water, the continuous belay system keeps you safe and secure when falling.

**AP**  
&  
PROJECTS

[www.ap-projects.be](http://www.ap-projects.be)

MAKING OUR **GLOBE**

INTO ONE **BIG ATTRACTION**



Inspiration  
A2

- **Bike Park with sustainable obstacles spread over the park.**



**A  
&  
P** PROJECTS  
[www.ap-projects.be](http://www.ap-projects.be)  
[www.ap-projects.be](http://www.ap-projects.be)

MAKING OUR **GLOBE**  
INTO ONE **BIG ATTRACTION**



Inspiration  
A3

- **Bouldering 3 m high, Sand or Fine gravel as fall arrest**



Artificial Rocks, in concrete  
with climbing holds.  
Fall arresting is sea sand.  
Can be used for bouldering or  
as a play element

**A  
&  
P**  
PROJECTS  
[www.ap-projects.be](http://www.ap-projects.be)  
[www.ap-projects.be](http://www.ap-projects.be)  
PROJECTS

MAKING OUR **GLOBE**  
INTO ONE **BIG ATTRACTION**



Inspiration  
A4

- **Low Rope Park, Teambuilding Park**



A Low rope park.  
Team-training, Teambuilding.  
Obstacles to overcome with  
the help of your team, your  
friends, your familie.



**AP**  
&  
PROJECTS  
[www.ap-projects.be](http://www.ap-projects.be)  
[www.ap-projects.be](http://www.ap-projects.be)  
PROJECTS

MAKING OUR **GLOBE**  
INTO ONE **BIG ATTRACTION**



Inspiration  
A5

- **Low Kids Adventure ropes**

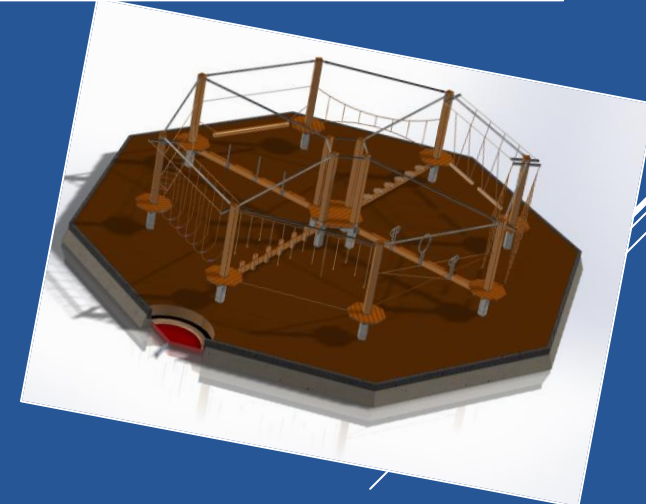
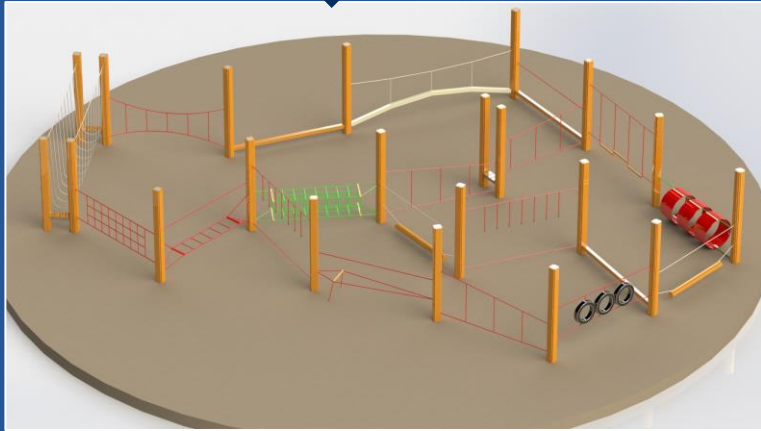

**A  
&  
P** PROJECTS  
[www.ap-projects.be](http://www.ap-projects.be)  
[www.ap-projects.be](http://www.ap-projects.be)

MAKING OUR **GLOBE**  
INTO ONE **BIG ATTRACTION**



Inspiration  
A6

- **Obstacle runs**



Single or double  
tracks

**AP**  
&  
PROJECTS  
[www.ap-projects.be](http://www.ap-projects.be)  
[www.ap-projects.be](http://www.ap-projects.be)

MAKING OUR **GLOBE**  
INTO ONE **BIG ATTRACTION**



Inspiration  
A7

- **Sports & Fitness tracks through the park for the fitness guru**

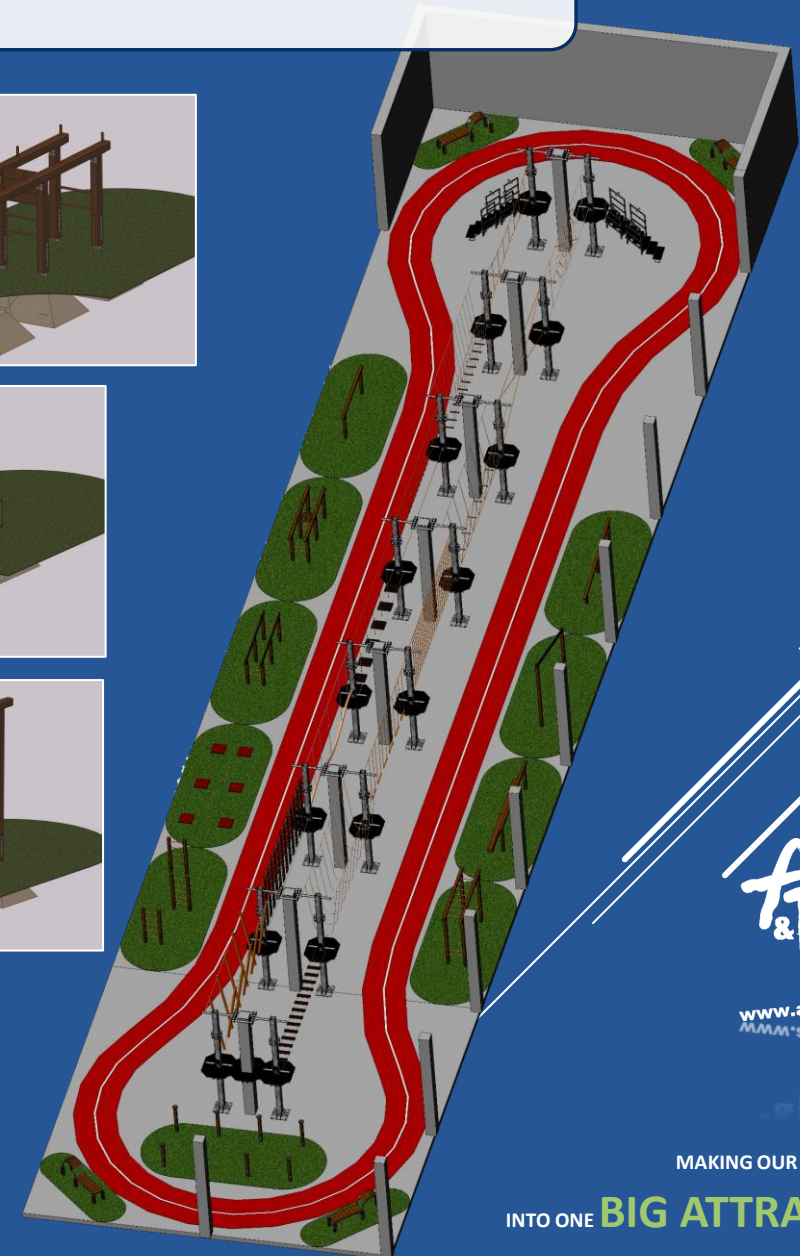
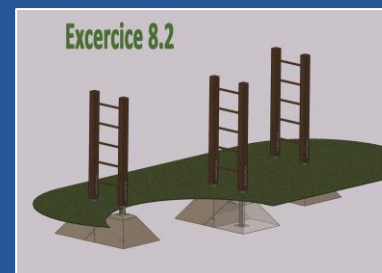
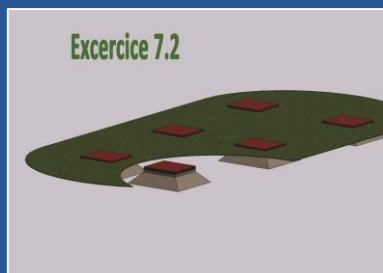
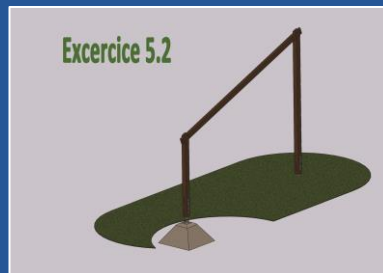
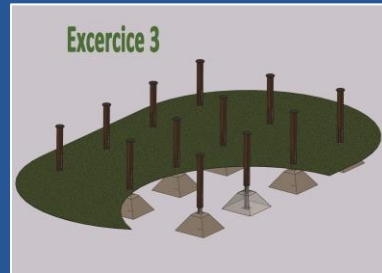
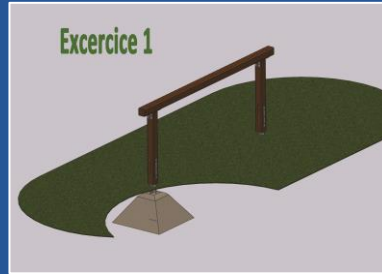

**AP**  
&  
**PROJECTS**  
[www.ap-projects.be](http://www.ap-projects.be)  
[www.ap-projects.be](http://www.ap-projects.be)

MAKING OUR **GLOBE**  
INTO ONE **BIG ATTRACTION**



Inspiration  
A8

- **Artificial caving**



Fixed or mobile add-on modules, equipped with evacuation hatches. The entire structure can be covered by a canopy.

**A & PROJECTS**  
[www.ap-projects.be](http://www.ap-projects.be)  
[www.ap-projects.be](http://www.ap-projects.be)

MAKING OUR **GLOBE**  
INTO ONE **BIG ATTRACTION**



Inspiration  
A9

- **Netpark with High Ropes**



Double layer of netting, under tension, for fall arrest. This activity requires maintenance. It is necessary to tighten the nets regularly. The lifespan of the nets is limited. Nets are often used for playing in despite the fact that it is a high rope course.

To have an attraction which is sustainable, the high rope track and the nets, has to be built between artificial steel poles.



Inspiration  
A10

- **Jump and fun net park with playelements**

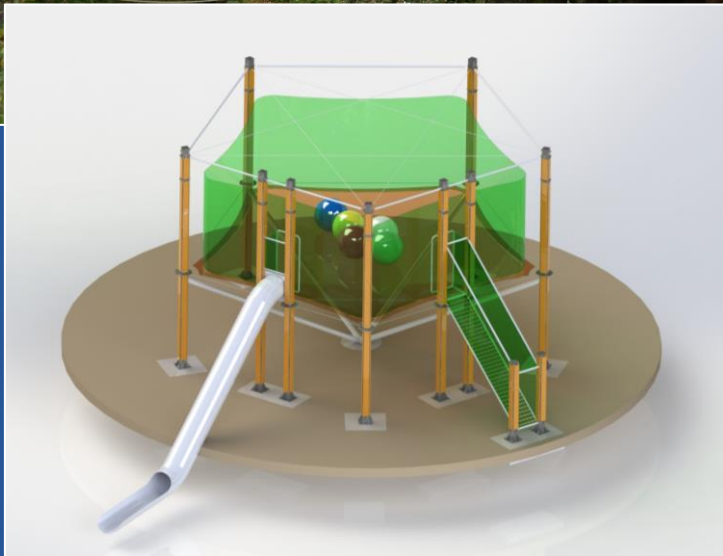
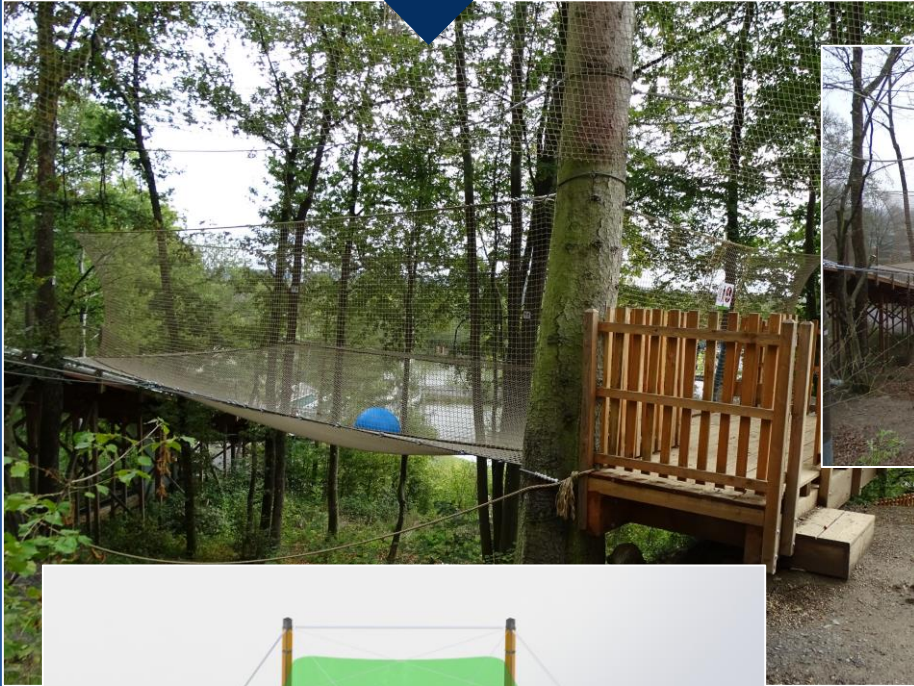

Triple layer of nets, under tension, for jumping and playing.  
Accessible for multiple persons.  
This activity has a high fun level  
The disadvantage of this activity is the high cost of maintenance, as the nets have to be stretched regularly.  
The lifespan of the nets is limited.

**A  
&  
PROJECTS**  
www.ap-projects.be  
www.ap-projects.be

MAKING OUR **GLOBE**  
INTO ONE **BIG ATTRACTION**



Inspiration  
A11

- **3D Labyrinth / 3D Maze with exits to find, to experience several attractions**

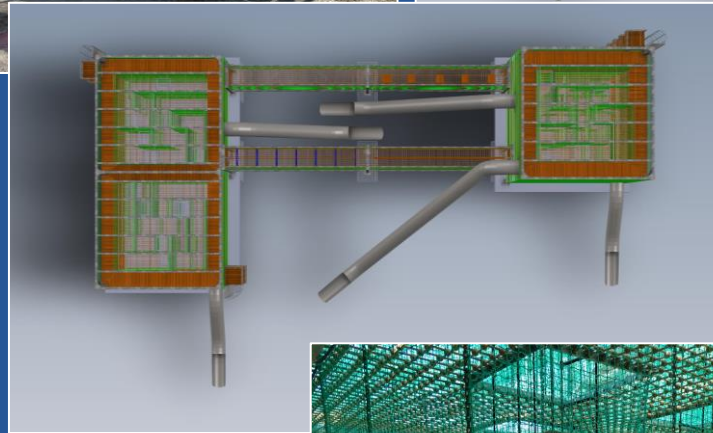
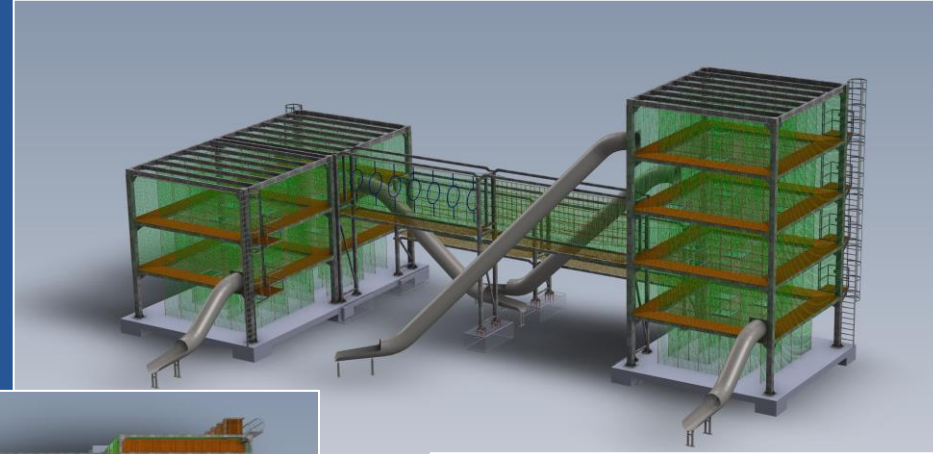

An amazing 3D-Maze, up to 12 metres high, with 5 floors full of adventure.

Lost For Hours

to find the exit,  
to find the entrance of several tube slide,  
to find connections between parts,  
going up - going down - to find a death end - to return to where you started - hoping to find the right track

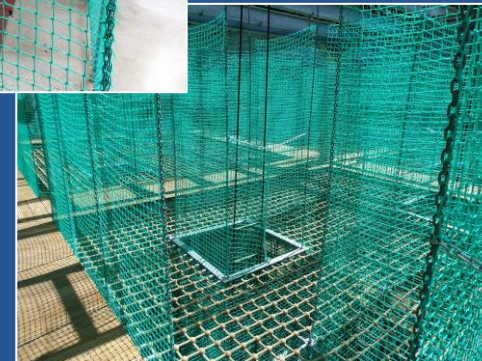

**A & PROJECTS**  
www.ap-projects.be  
www.ap-projects.be

MAKING OUR **GLOBE**  
INTO ONE **BIG ATTRACTION**



- **Activities with lifelines and/or climbing gear in open air**

1. High rope adventure with 4 floors and the difficulty levels kids, green, blue, red and black
2. Standard climbing wall on climbing grips
3. Quick jump
4. Quick jump zip
5. Straight multiple Ziplines
6. Kidsziptrack
7. Zip with turns
8. Outdoor Funclimbing paradise
9. Via Ferrata on boulderingrocks

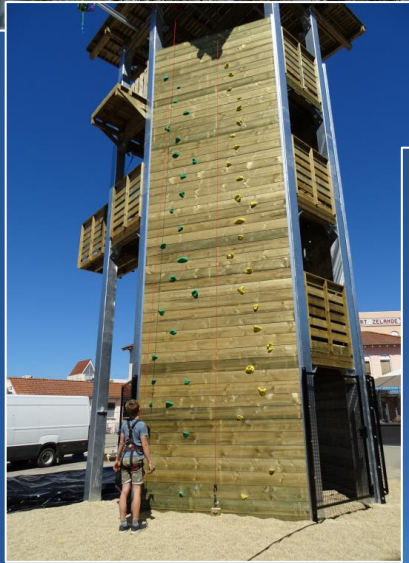

MAKING OUR **GLOBE**  
INTO ONE **BIG ATTRACTION**

**AP**  
&  
**PROJECTS**

[www.ap-projects.be](http://www.ap-projects.be)  
[www.ap-projects.be](http://www.ap-projects.be)

1201012



Inspiration  
B1

- **High Rope Park - 3/4 levels - difficulty levels kids, green, blue, red and black**

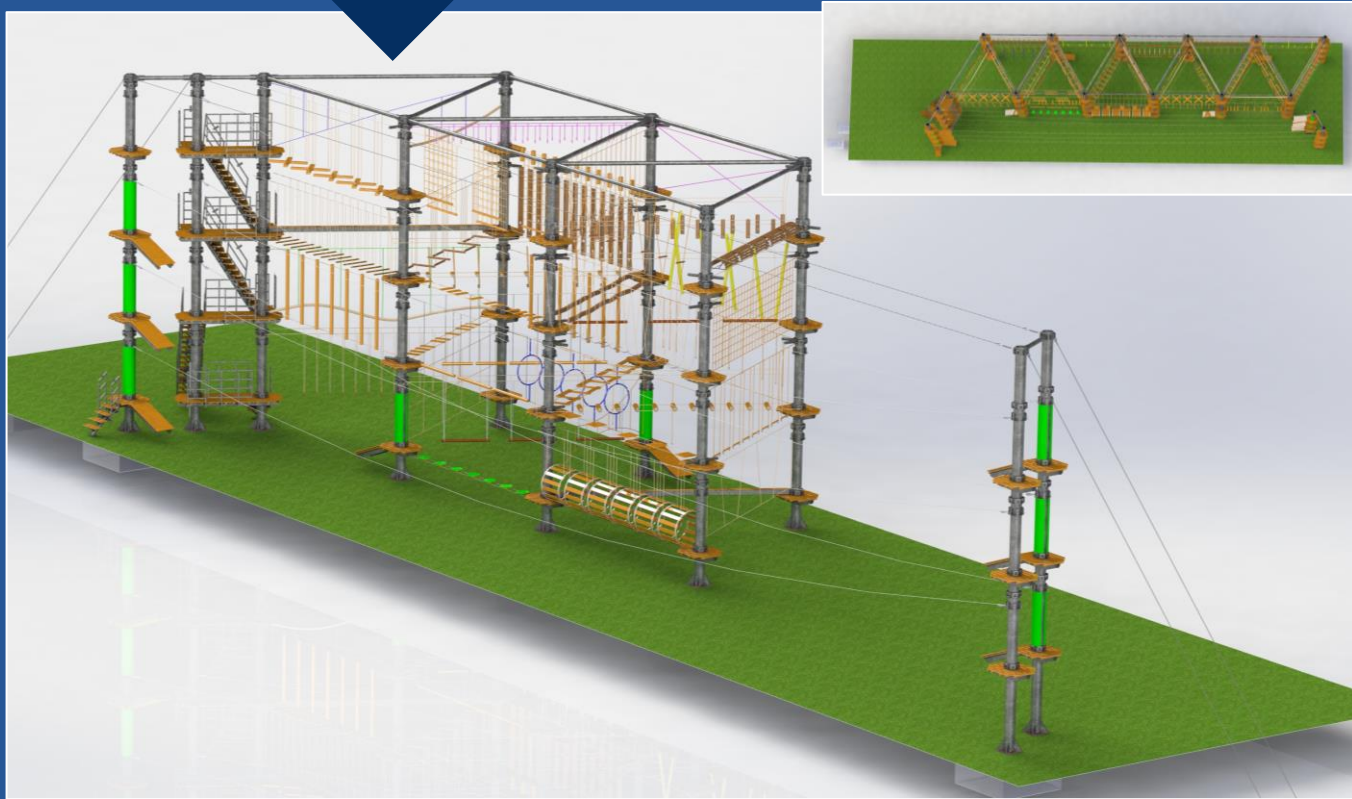

The high Rope Adventure park can be the top adventure activity of your parc.

The structure can be built-up with 3 or 4 levels. With 4 levels, you probably need a fencing around the structure. The tracks can have different levels of difficulty. The structure is sustainable, it is an investment which lasts for ever. The continuous belay system in the track is a system, which requires less personal. You do not need permanent supervision. Only some good instructions are needed for exploitation.

**A  
&  
P**  
PROJECTS

[www.ap-projects.be](http://www.ap-projects.be)  
[www.ap-projects.be](http://www.ap-projects.be)

MAKING OUR **GLOBE**

INTO ONE **BIG ATTRACTION**



Inspiration  
B1

- **High Rope Park - 3/4 levels - difficulty levels kids, green, blue, red and black**

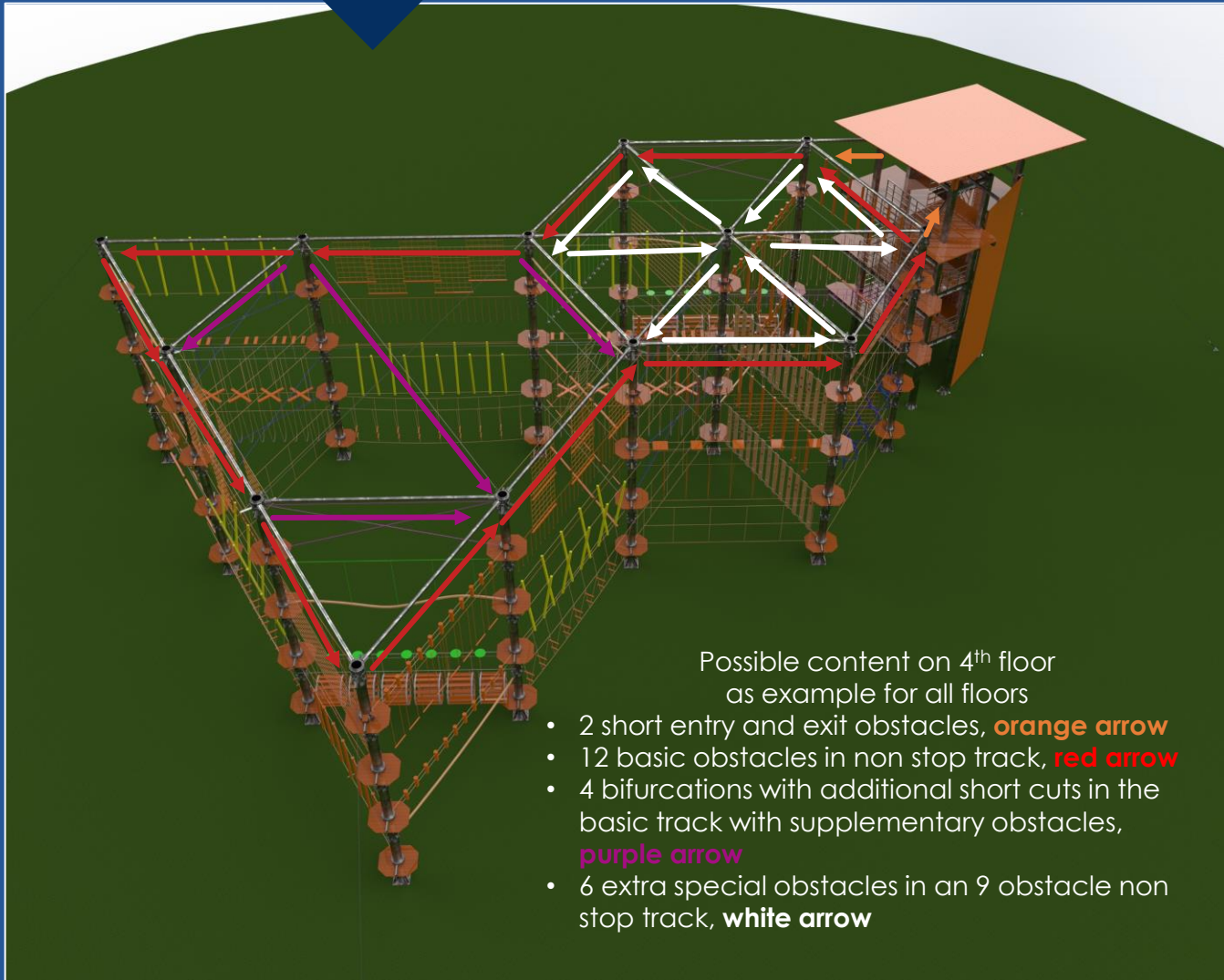

Possible content on 4<sup>th</sup> floor  
as example for all floors

- 2 short entry and exit obstacles, **orange arrow**
- 12 basic obstacles in non stop track, **red arrow**
- 4 bifurcations with additional short cuts in the basic track with supplementary obstacles, **purple arrow**
- 6 extra special obstacles in an 9 obstacle non stop track, **white arrow**

- 3 or 4 levels in the structure.
- Depending on the rules in the country, a fencing must be built around the hirope structure if it has an accessible lower ground level for kids.
- If the structure is built as shown on the picture, you can have several tracks on each level (floor).
- Ground floor can be a kids rope course and a kids zip track.
- Second floor is the green level,
- Third floor is the Blue level,
- Fourth floor is the Red/Black Level.
- In all levels, you can have bifurcations to other tracks on the same floor.
- You can start with a minimum number of obstacles in the track and add more after some time.
- Example in picture of fourth floor.
- The white arrows can be a black difficult track.

**A  
&  
P**  
PROJECTS  
[www.ap-projects.be](http://www.ap-projects.be)  
[www.ap-projects.be](http://www.ap-projects.be)

MAKING OUR **GLOBE**

INTO ONE **BIG ATTRACTION**



Inspiration  
B2

- **Wall climbing several tracks on adventure tower**



3 standard climbing tracks on 2 sides of the tower

3 X

3 X

If needed, wall can be closed with fencing

**AP**  
&  
PROJECTS

[www.ap-projects.be](http://www.ap-projects.be)  
[www.ap-projects.be](http://www.ap-projects.be)

MAKING OUR **GLOBE**

INTO ONE **BIG ATTRACTION**



Inspiration  
B3 & B4

- **Quick Jump & Quick Jump zip**



Automatic fall breaking system for jumping of tower.



**AP**  
&  
PROJECTS  
[www.ap-projects.be](http://www.ap-projects.be)  
[www.ap-projects.be](http://www.ap-projects.be)

MAKING OUR **GLOBE**

INTO ONE **BIG ATTRACTION**



Inspiration  
B5

- **Multiple straight zip tracks**

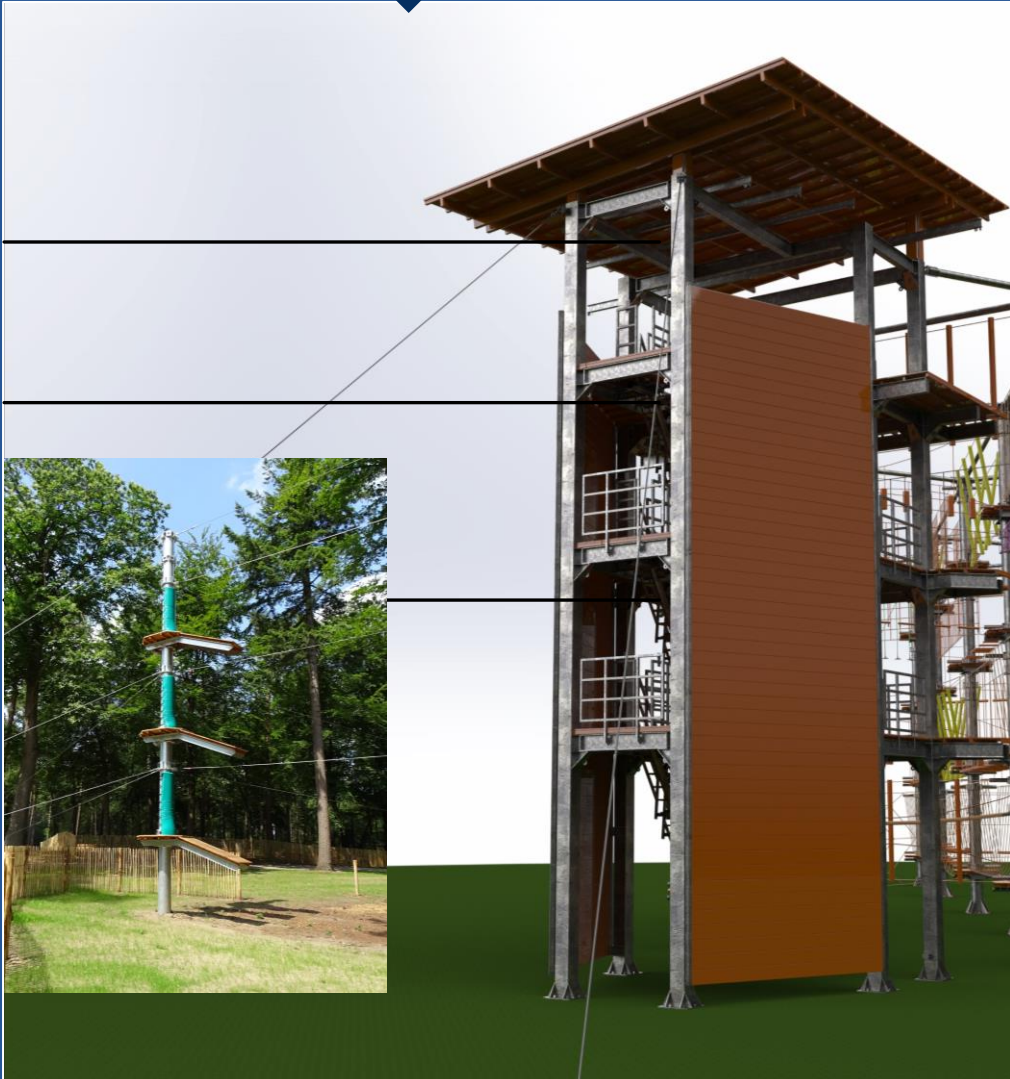

Multiple shorter zip-tracks on different levels, to create more action on the same moment. More and shorter zips create more financial return in time comparing with a single very long zip.

Several zips creates more fun, creates more sense of reliving again. Competing on a zip with an second person makes more fun.

**A  
&  
PROJECTS**  
[www.ap-projects.be](http://www.ap-projects.be)  
[www.ap-projects.be](http://www.ap-projects.be)

MAKING OUR **GLOBE**

INTO ONE **BIG ATTRACTION**



Inspiration  
B6

- **Kidsziptrack**

At level 1 in the high rope park,  
ziptrack for kids  
Or with additional posts with  
landing platforms, a separated  
kidsziptrack

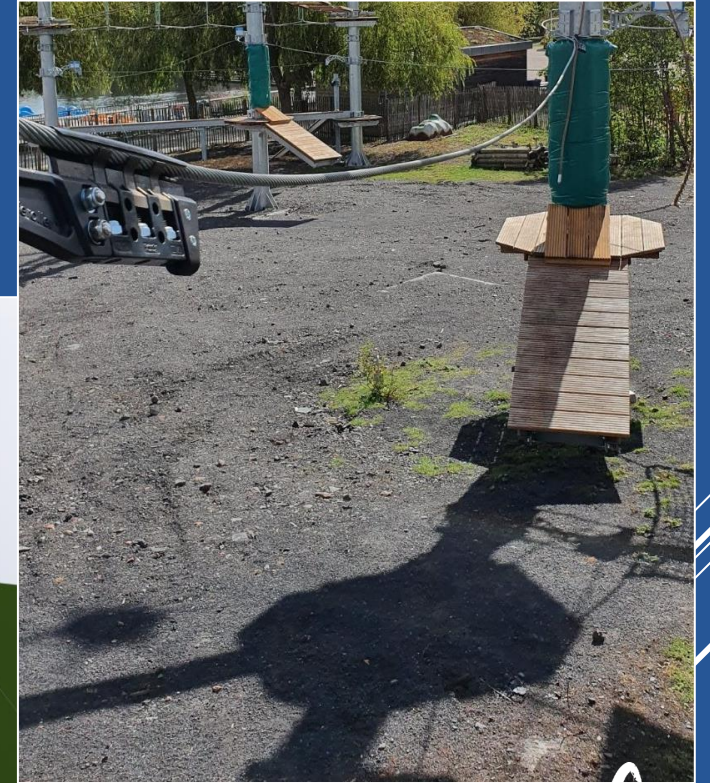
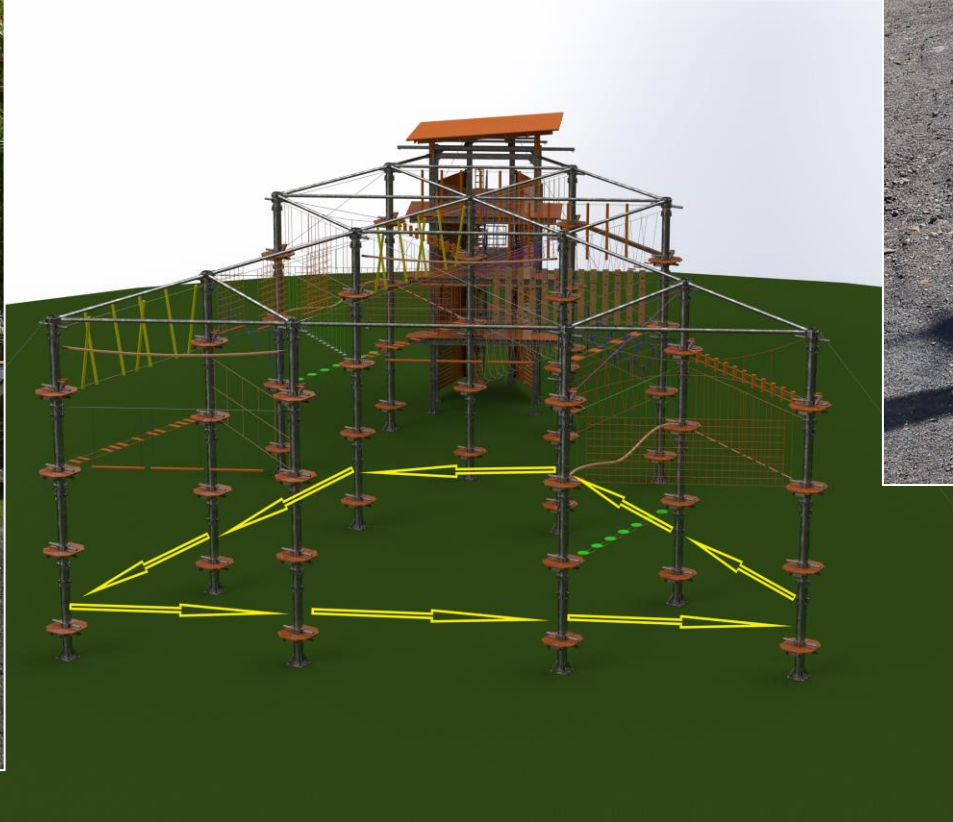

**AP**  
&  
PROJECTS  
[www.ap-projects.be](http://www.ap-projects.be)  
[www.ap-projects.de](http://www.ap-projects.de)

MAKING OUR **GLOBE**  
INTO ONE **BIG ATTRACTION**



Inspiration  
B7

- **ZIP WITH TURNS**

A zip on a double cable for extra safety. It is not a rollercoaster, It is a zip with turns. A ride through your park with turns over a longer distance for an acceptable price. It's an extension for your adventure tower.

An endless ziptrack with turns, Riding down a complete mountain from top to valley.

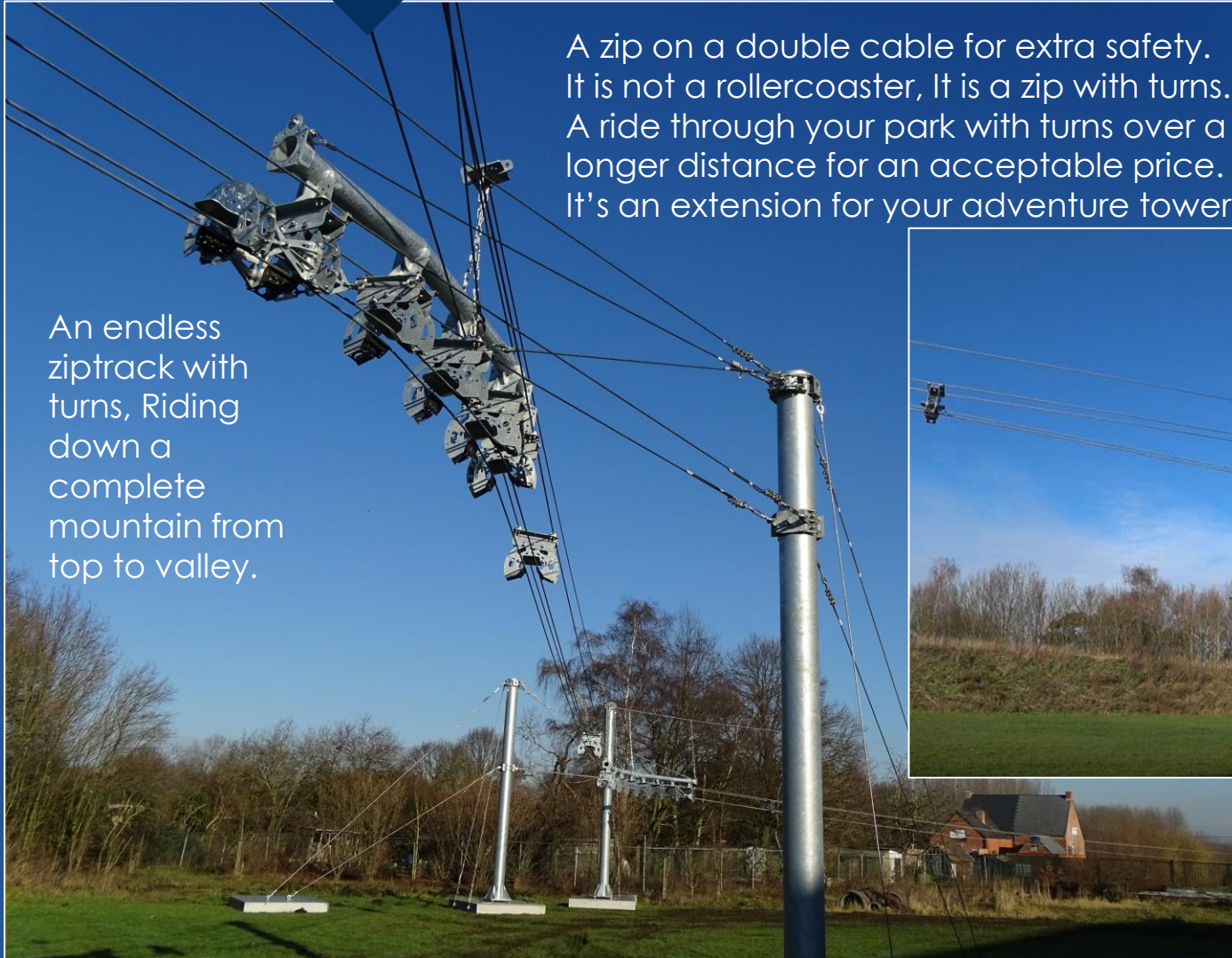

**A  
&  
PROJECTS**

[www.ap-projects.be](http://www.ap-projects.be)  
[www.ap-projects.be](http://www.ap-projects.be)

MAKING OUR **GLOBE**

INTO ONE **BIG ATTRACTION**



Inspiration  
B8

## • Fun-Climbing

Fun climbing elements outside.  
9 different climbing elements on 2  
towers.  
Automatic fall devices. Sand or fine  
stones as fall arrest.  
If build in the Netherlands you need  
fencing around.

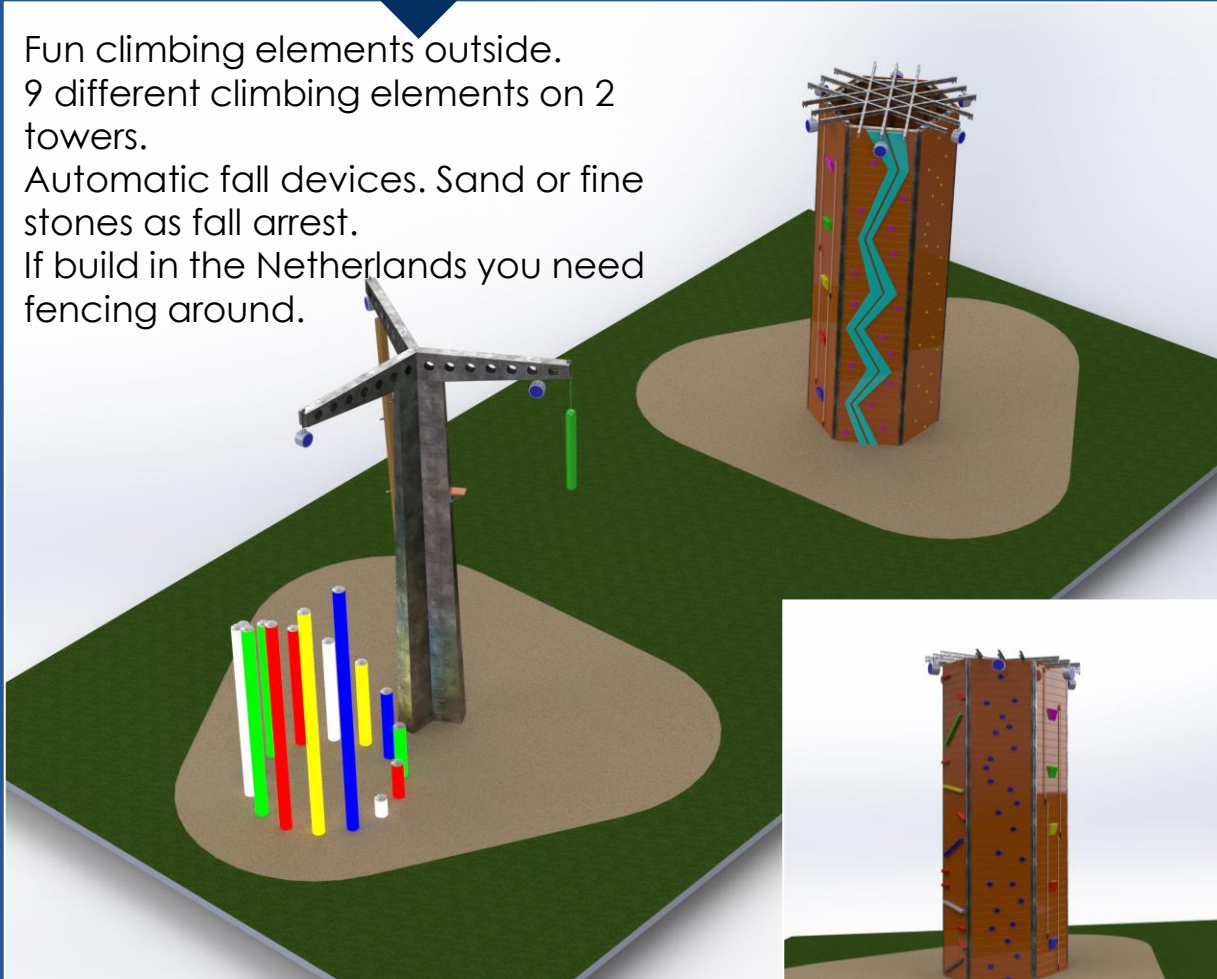

**AP**  
&  
PROJECTS  
[www.ap-projects.be](http://www.ap-projects.be)  
[www.ap-projects.be](http://www.ap-projects.be)  
PROJECTS

MAKING OUR **GLOBE**  
INTO ONE **BIG ATTRACTION**



Inspiration  
B9

## • Via ferrata on bouldering rocks



- Artificial rocks, in concrete with additional climbing grips and stainless steel supports.
- Sea sand or very fine gravel serves as fall arrest.
- A via ferrata is built on the rocks and on any neighbouring buildings or structures.
- A cable is used as a lifeline, like in the mountains

**A  
&  
P**  
PROJECTS  
[www.ap-projects.be](http://www.ap-projects.be)  
[www.ap-projects.be](http://www.ap-projects.be)  
PROJECTS

MAKING OUR **GLOBE**  
INTO ONE **BIG ATTRACTION**



- **Activities with or without lifelines and/or climbing gear indoor**

1. Indoor High rope adventure in posts with 3/4 floors and the difficulty levels kids, green, blue, red and black.
2. Indoor Suspending High rope adventure with 1 (max 2) floors and the difficulty levels kids, green, blue, red and black.
3. An indoor multiple zipparadise, cruising on a zipwire through a building, light effects and dreamy music create a mystical atmosphere.
4. All activities which can be built outside, can be created inside, even a suspending high rope park above a tropical swimming pool.

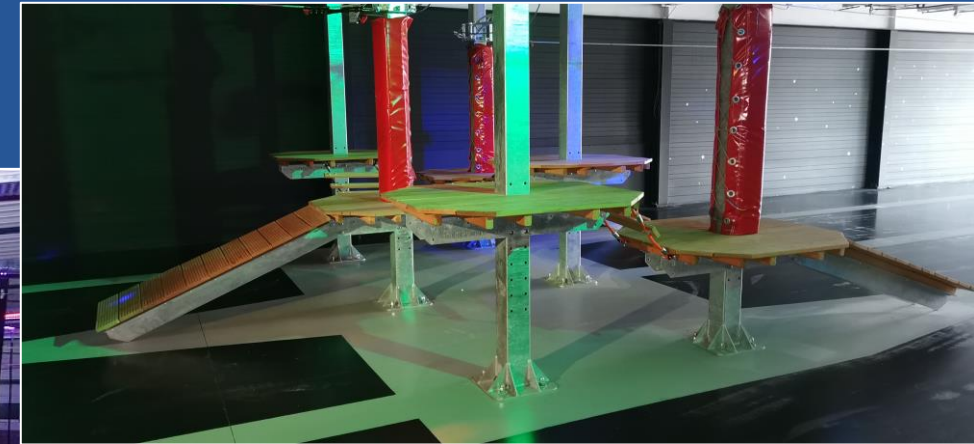
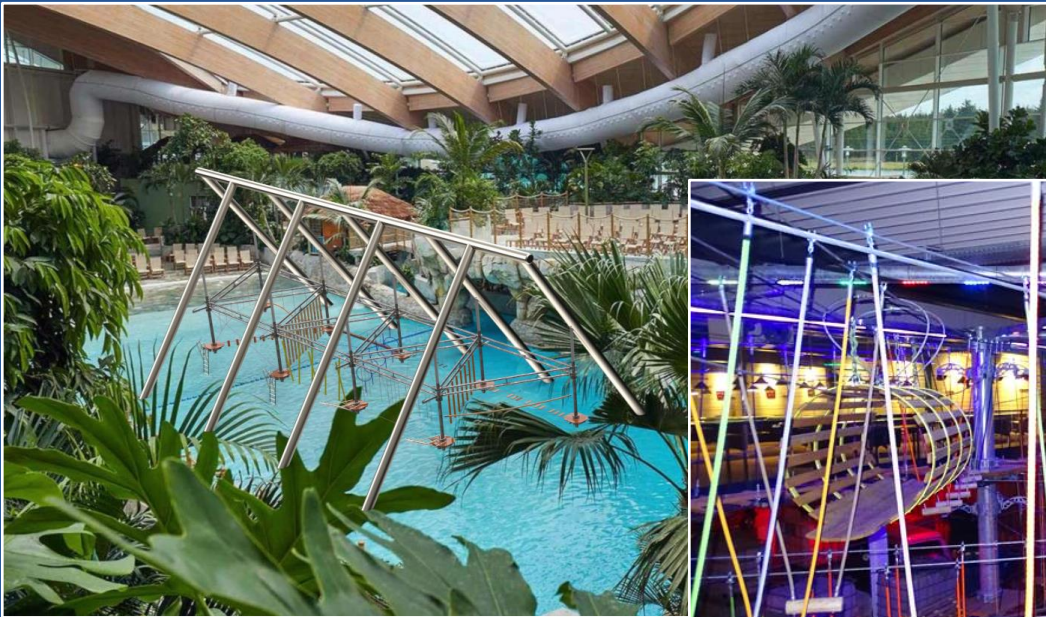

MAKING OUR **GLOBE**  
INTO ONE **BIG ATTRACTION**

**AP**  
&  
**PROJECTS**

[www.ap-projects.be](http://www.ap-projects.be)  
[www.ap-projects.be](http://www.ap-projects.be)

PROJECTS



Inspiration  
C1

- **Indoor High ropes on posts**



When weather is too rainy, or outside the temperature is too high, or darkness has fallen outside, you still can have some adventure activity inside

The structure can be built in posts, with 2, 3 or 4 levels depending on the height of the building.

Combining high rope obstacles and zip wires, creates a lot of fun inside.

**A  
&  
P**  
PROJECTS  
[www.ap-projects.be](http://www.ap-projects.be)  
[www.ap-projects.de](http://www.ap-projects.de)

MAKING OUR **GLOBE**  
INTO ONE **BIG ATTRACTION**



Inspiration  
C2

- **Indoor suspending High ropes**

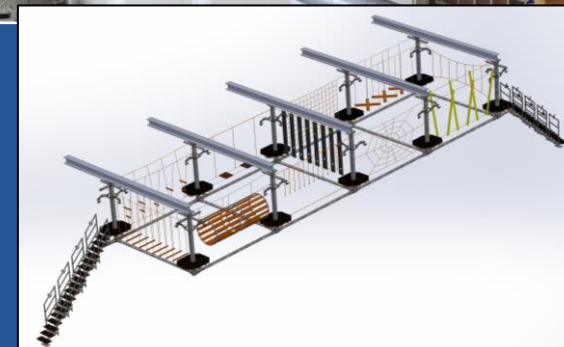

You have a gym, an indoor trampoline park, an indoor play area, an indoor event hall, etc. ... with lots of free height space at the ceiling!

You can hang a suspended High rope course from that ceiling, depending on the free height, with 1 or 2 levels of adventure.

The space underneath can be used for other activities.

**A  
&  
P**  
PROJECTS

[www.ap-projects.be](http://www.ap-projects.be)  
[www.ap-projects.be](http://www.ap-projects.be)

MAKING OUR **GLOBE**

INTO ONE **BIG ATTRACTION**



Inspiration  
C3

- **Low height or normal height Indoor zip-paradise**

Cruising on a zip wire  
through a building



Light effects and dreamy music  
create a mystical atmosphere  
Coming soon : VR experience



**A  
&  
P** PROJECTS  
[www.ap-projects.be](http://www.ap-projects.be)  
[www.ap-projects.be](http://www.ap-projects.be)

MAKING OUR **GLOBE**  
INTO ONE **BIG ATTRACTION**



Inspiration  
C4

- **High Ropes above a swimming pool without a life line**



An extra attraction for indoor and outdoor swimming paradises. A Rope Park suspending on the roof or on an extra structure above the water. Height of falling down 1 - 2 m.

There is an hoisting system in the poles to lift the totality, when not used.



MAKING OUR **GLOBE**  
INTO ONE **BIG ATTRACTION**

Contact:  
A&P Projects  
Hertstraat 42 B  
2590 Berlaar  
Belgium

Paul Huybrechts  
[design@ap-projects.be](mailto:design@ap-projects.be)

Phone: +32 15 761 561  
Mobile: +32 475 761 561



[www.ap-projects.be](http://www.ap-projects.be)

[www.ap-projects.be](http://www.ap-projects.be)

PROJECTS



[www.ap-projects.be](http://www.ap-projects.be)

[www.ap-projects.be](http://www.ap-projects.be)

PROJECTS

MAKING OUR **GLOBE**  
INTO ONE **BIG ATTRACTION**